



endolite

get busy living

Instructions for CaTech Hydraulic Control Cylinders

(These instructions to be used in conjunction with fitting instruction 938216 also supplied with the cylinder)
Hydraulic cylinders used to control the swing and/or stance in a Trans-femoral lower limb external prosthesis during normal locomotion.

CaSwing 300SR/1 Cylinder only 932262

CaStance 700R Cylinder only 932260

SFESK 300SR/1 Module 019156

140° SFESK 300SR/1 Module 019169

EUK 700R Module 019150

EUK 4 Bolt 700R Module 019350

SFEUK 700R Module 019163

All ESK+ Modules



**Maximum amputee weight refer to the
fitting instructions supplied with the knee.**

Fitting Instructions for CaTech Hydraulic Cylinders

For fitting a CaTech hydraulic cylinder to a Blatchford 160 Hi-Activity Cradle refer to instructions 938008.

For guidance on adjustment & alignment refer to the CaTech documentation supplied with each cylinder.

The wearer is to be warned that during and after very energetic use the cylinder may become hot.

STORAGE AND HANDLING: When storing for prolonged periods place cylinder vertically with trunnion uppermost. Alternatively and in addition, air management may be assisted by cycling the cylinder several times with the stance resistance switched off (load the toe whilst raising stirrup lever on piston rod). Use product packaging supplied.

User/attendant should be aware of potential finger trap hazards at all times.

Fitting Kits: SFESK 019956; EUK 019950; ESK+ Full Form Shin 019969; ESK+ Demountable Shin 019856

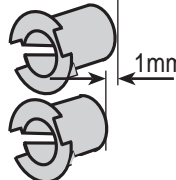
	<p>NOTE: Chassis Rear Pivot Bearings (923700) are approximately 1mm longer than the Lower Pivot Bearing (334303) in shin. Identify these correctly before proceeding with assembly.</p>
---	--

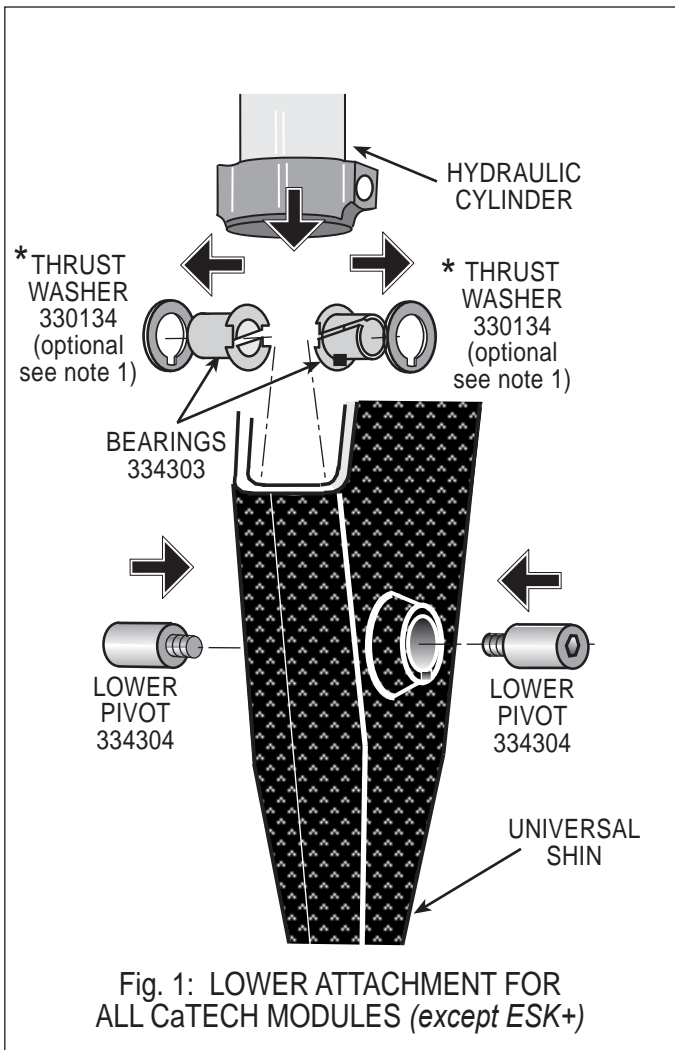

LOWER ATTACHMENTS (Fig.1) except ESK+

1. Where sufficient clearance exists, assemble Thrust Washers onto Bearings, as shown, before inserting Bearings into shin. Ensure the anti-rotation key on each Bearing is correctly located in the appropriate slot in the Washer and shin.
- * Before the final assembly of the Lower Pivots, put the Hydraulic Cylinder into the shin and position between the Lower Pivot Bearings. If there is insufficient clearance between the bearings and the cylinder then BOTH Thrust Washers must be removed.
2. Apply a very light smear of STP Oil Treatment (928105) to each Lower Pivot.



3. Apply Loctite 222 Screw Lock (926001) to threads on Lower Pivots and with Hydraulic Cylinder positioned with assembly holes aligned with Bearings, insert Pivots and carefully tighten into the Cylinder base.

Fitting Instructions for CaTech Hydraulic Cylinders

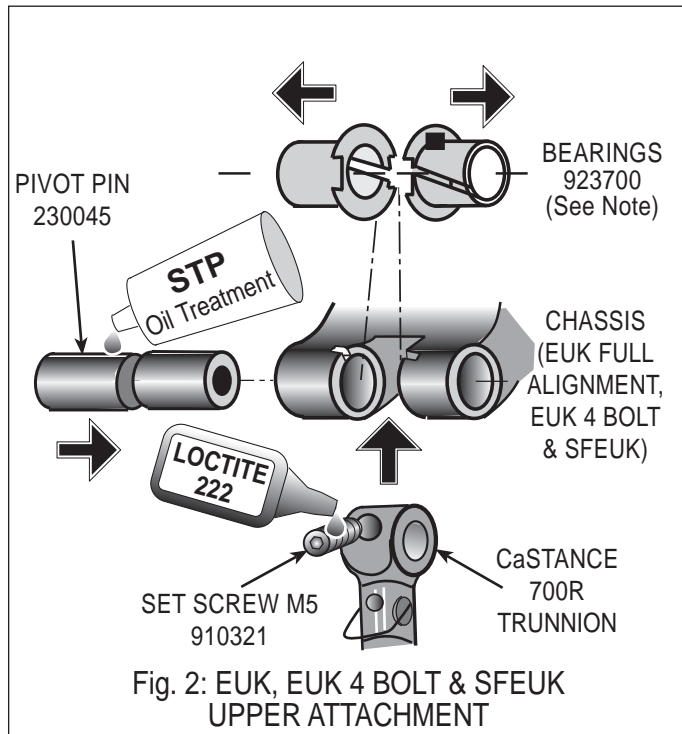

UPPER ATTACHMENT (Figs. 2 & 3) *except ESK+*

1. Ensure that the anti-rotation key on each bearing is correctly located in the appropriate slot. SFESK chassis outside of lugs. EUK and EUK 4 Bolt chassis inside of lugs.

For Fitting Kit 019950 EUK (Fig. 2)

- 2a. Apply a very light smear of STP Oil Treatment (928105) to the Rear Pivot Pin.
- 3a. Position CaStance 700R Cylinder Trunnion between Chassis Rear Lugs and insert Rear Pivot Pin into the Chassis. Gently push through and centralise.
- 4a. Apply Loctite 222 Screw Lock (926001) to the M5 Set Screw and tighten into groove of the Rear Pivot Pin.

For Fitting Kit 019956 SFESK (Fig. 3)

- 2b. Apply a very light smear of STP Oil Treatment (928105) to Bearing surface only on Bolt and Nut - Upper Attachment.

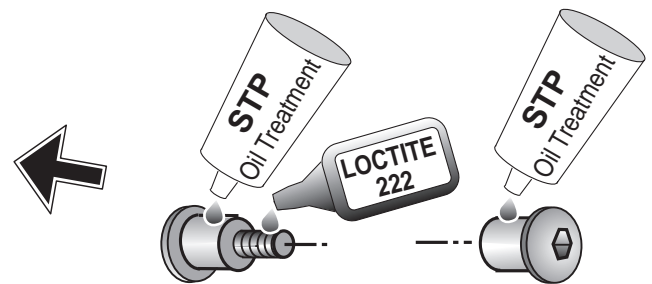

- 3b. Apply Loctite 222 Screw Lock (926001) to thread of Bolt - Upper Attachment.
- 4b. Position Hydraulic Cylinder Trunnion between Chassis rear lugs.
- 5b. Insert Bolt and Nut through Bearings in Chassis rear lugs and carefully tighten

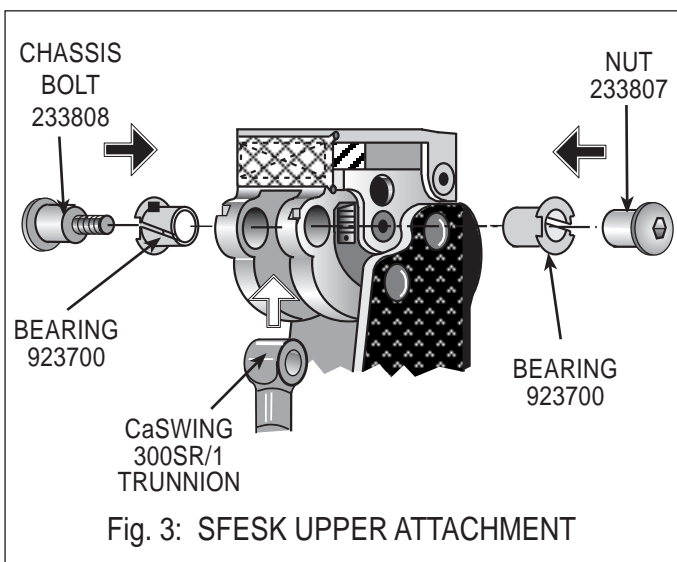

Fitting Instructions for the HYD CYL to ESK+ Shin Modules

ESK+ Full Shin

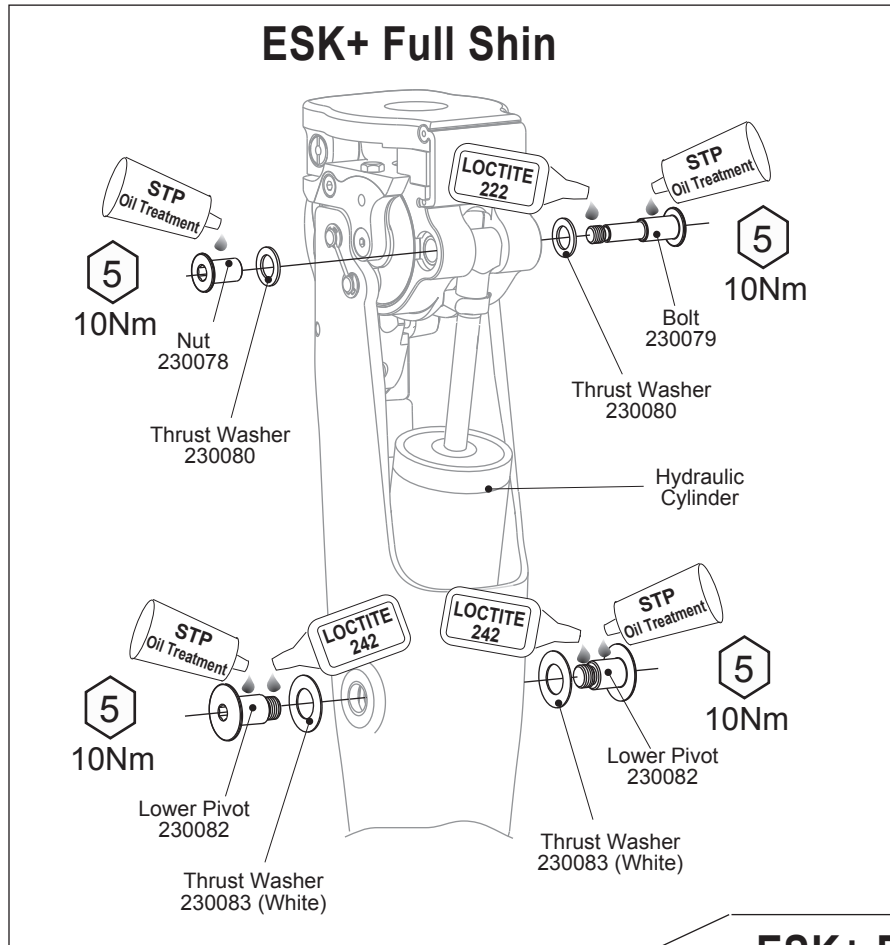

Remove silencing ring and discard prior to fitting cylinder into either ESK+ shin.

ESK+ Demountable Shin

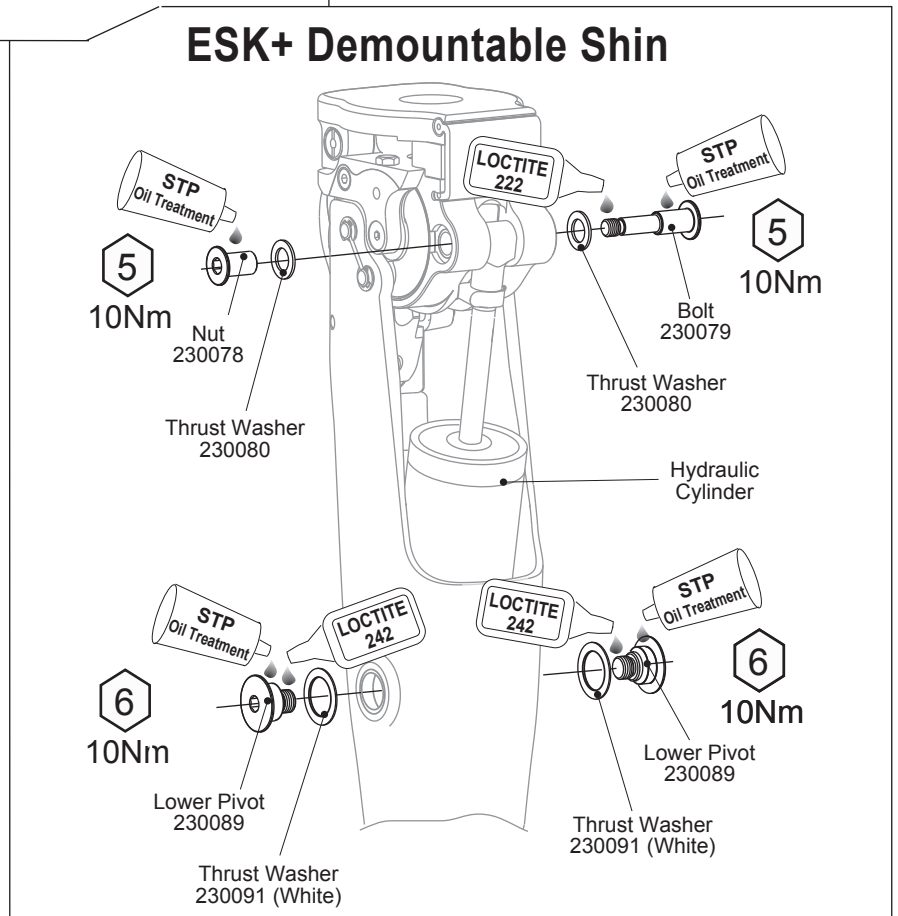

Blatchford Products Ltd

Lister Road, Basingstoke, Hampshire,
RG22 4AH, United Kingdom
Telephone: +44 (0)1256 316600
Facsimile: +44 (0)1256 479705
Email: sales@blatchford.co.uk
www.endolite.co.uk

938058WEB/06-0110